

**ROBAM**



## Operation Manual

**CXW-200-A809**

**CXW-200-A818**

Range Hood

# Contents

1.Important .....	1
2.Introduction.....	1
3.Installation Instructions.....	2
4.Use.....	5
5.Maintenance .....	7
6.Electrical Diagram.....	9
7.General Troubleshooting.....	9

Dear user

Thank you very much for choosing ROBAM range hood. Please read the manual carefully before using the product.

## Important

### Packaging of New Hood

Please dispose the packaging materials in an environmentally-friendly way to maintain a good environment.

Keep children away from the plastic film and packing carton. They are not toys and may cause choking.

### Disposal of Old Hood

If the old hood cannot be used any longer, it is recommended to dispose it to an “unusable” state before discarding.

Please assist disposing or recycling the useable materials from the old hood, thus contributing to the environmental protection.

### Before Using the New Hood

The range hood exhausts fumes outside.

Before installing and using the product, please carefully read and strictly follow the instructions and accompanying documents. When necessary, also read the Operation Manual of your gas hob and save them properly for future reference.

As the manual apply to different types of hoods, you may find some extra characteristics described here.

If obvious damage is found, do not energize it and immediately contact your local dealer or the service center.

Don't let unsupervised children and frail people use the hood alone. Otherwise, it will cause electric shock or other injuries.

## Introduction

### Technical Specification

Model	CXW-200-A809 CXW-200-A818	Noise	≤57.5dB
Power supply	220-240V~ 50Hz	Rated input power of the hood	204W
Full pressure efficiency	≥23%	Rated input power of the main motor	200W
Nominal pressure	≥280Pa	Maximum input power of the light	≤4W
Air flow rate	18m <sup>3</sup> /min	Dimensions (L×W×H)	A809: 895×524×597(mm) A818: 895×504×652(mm)
Maximum static pressure	≥350Pa	Net weight of the host	A809: 25.5kg A818: 26kg
Odor decrease rate (normal)	≥98%	Grease separation rate	≥96%
Odor decrease rate (instantaneous)	≥80%		

1. The deviation between the specified value and actual value of airflow shall not exceed 10% of the specified value.
2. When stir-frying function is enabled, the power will increase by 5% compared to strong power (level-3) and the airflow is 19 m<sup>3</sup>/min.

Figure 1

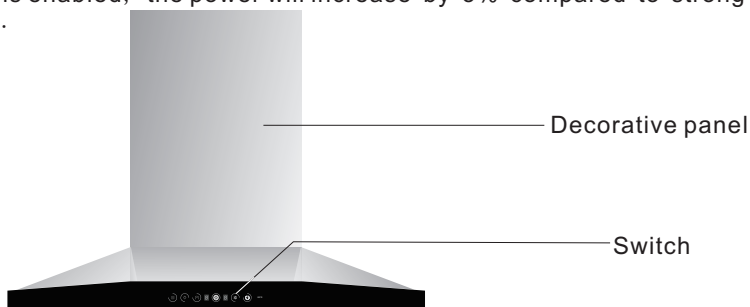

Contents indicated by  are warnings. Failure to follow the instructions will cause danger.

## Body Size

Figure 2

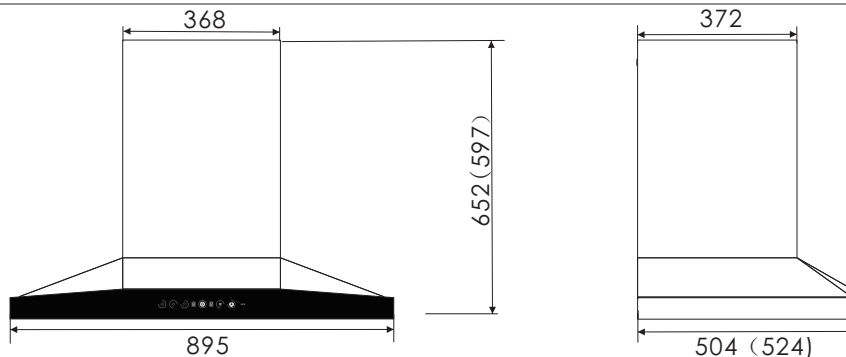

The marked sizes are for reference only. Size in the brackets is specific to A809 hood. (Unit: mm)

## Installation Instructions

### Warning

1. Flue gases shall not be discharged to the hot flue, which is exclusively used for discharging the combustion gas or other fuel fumes.
2. Note that when installing the metal expansion pipe, the pipe shall match perfectly with the hole in size. Overlarge hole is prohibited, as it will result in loose pipe and accidental drops.
3. If the hood is used together with a cooking hob burning gas or other fuels, the room must be well ventilated.
4. Flue diameter smaller than that of the exhaust pipe will affect the hood efficiency. So will overlong exhaust pipe.
5. Regulations concerning the discharge of air have to be fulfilled.

### Preparation for Installation

#### ● Surroundings

Keep the hood away from too many doors and windows, so as to avoid air convection affecting the efficiency.

-  The hood is for daily household use. Please do not operate it in special circumstances (e.g. outdoor), nor use it to discharge hazardous or explosive substances or gases. Before installation, the product shall be placed in a dry and ventilated place without corrosive and harmful gases.

#### ● Tools

The hood will be installed with the following tools: 1). an impact drill (with drill bit); 2). a wrench; 3). a screwdriver; and 4). a ruler.

#### ● Check the items in the box

Packing List	No.	Name	Quantity	No.	Name	Quantity
	1	Hood	1 piece	9	Check valve	1 set
	2	Φ175 (OD) aluminum exhaust pipe	1 set	10	ST4×18 self-tapping screw	10 pieces
	3	Φ175 (OD) exhaust pipe joint		11	ST4.8×50 wood screw	4 pieces
	4	Fixed bar for exhaust pipe		12	Hitching foot stopper	1 piece
	5	Exhaust pipe tape		13	M6 metal expansion pipe	1 pair
	6	Plastic expansion pipe	4 pieces	14	Hitching foot	1 piece
	7	Operating Instructions	1 piece	15	Oil cup	2 pieces
8	Envelope	1 piece				

Note: There are 2 oil cups provided, one as spare oil cup and the other to be installed on the hood. When using the hood, install the cup on the filter mesh.

## Installation Notes

Figure 3

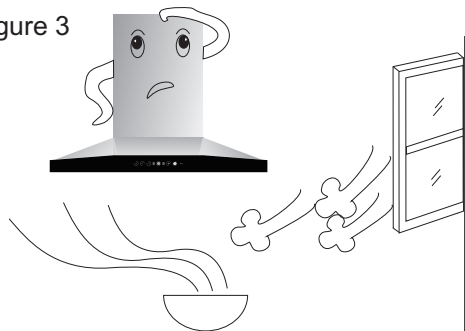

● Don't install the hood too high and protect it from outside airflow interference, so as not to reduce the efficiency.

Figure 4

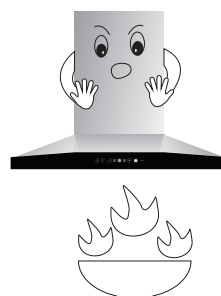

⚠ Warning: put out the fire promptly after use. Don't use the hob to bake the hood directly. Don't cook food directly under the hood. Otherwise, it will damage the hood, causing accidents.

Figure 5

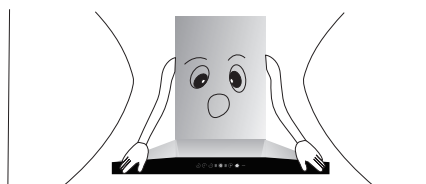

● When making cupboard, save room for the hood body to facilitate the maintenance and repair.

Figure 6

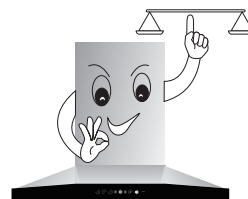

● During installation, please keep the body level.

Figure 7

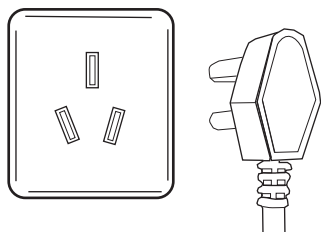

● Use fittable plug and have it well grounded. (The picture for reference only, please subject to actual plug)

Figure 8

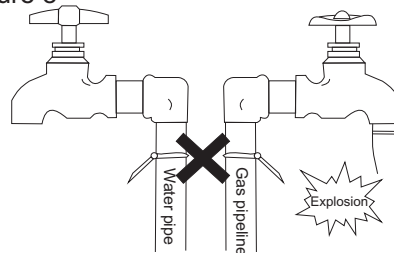

● The water pipe is not well grounded ● Gas pipeline grounding may cause fire and explosion.

Please also note that:

- Do not expose the hood if your kitchen is under renovation, because construction materials, dusts, paint, coatings, and emitted gases will corrode and tarnish the hood surface. Therefore, it is recommended to install it after the renovation is completed.
- Don't install the hood on wood and other combustible walls. The wall shall be made of noncombustible materials with enough strength.
- Installation and circuit setting must be done by experienced professionals. Non-professionals are not allowed to install, dismantle and repair the hood.
- The hood may have very sharp edges. So, please wear protective gloves during hood installation, cleaning or repair.
- When drilling on the wall, keep away from embedded wires to avoid fire.

## Installation

**1. Determine the position:** the size of removable baffle (reference: 430mm) can be adjusted according to the actual situations. The installation pitch of holes is shown in Figure 10-1. The hook body shall be centered vertically and kept level. Ceiling hole size is shown in Figure 10-2.

▲ The hood shall be installed right above the hob. The minimum distance between the bearing surface of cooking appliance and the lowest part of hood is 650mm (larger space specified in the installation instruction of gas hob shall be considered, if any; the distance for electric cooker may be reduced appropriately, depending on the actual situations).

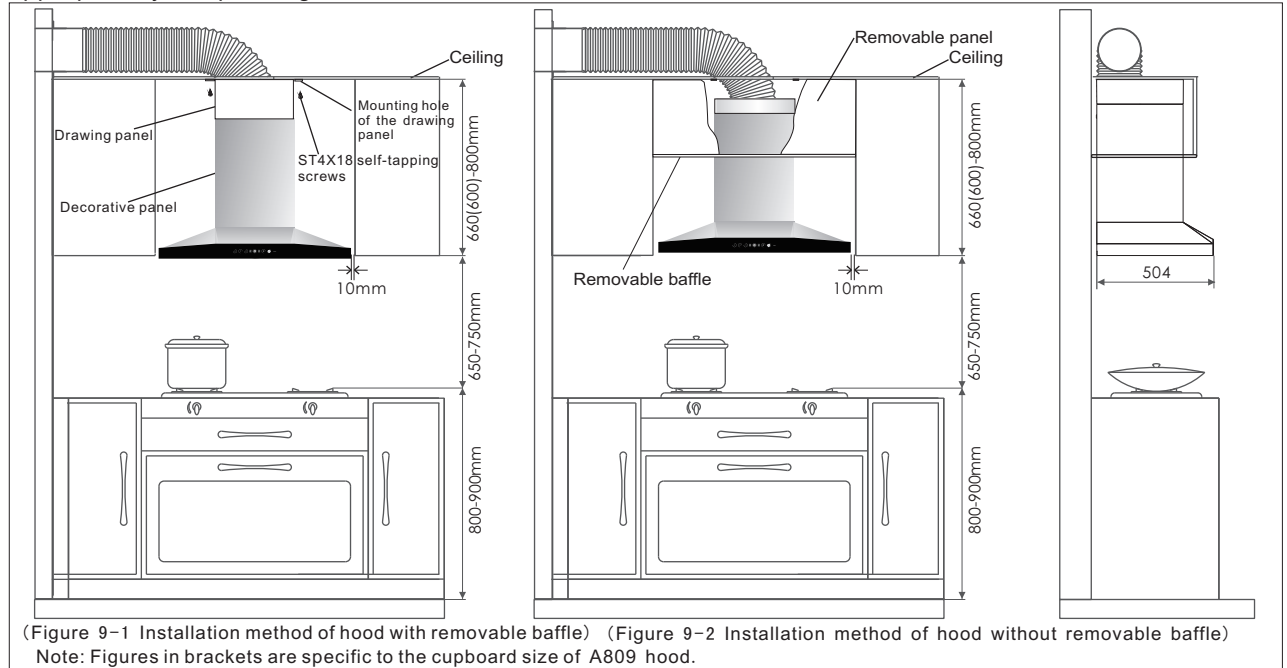

**2. Install hitching feet:** according to the size of the hitching feet, drill four 50-60mm-deep holes on the wall accordingly with an 8mm-diameter drill bit (overlarge holes are prohibited). Press the expansion pipe into the holes, and then fix the hitching feet with 4 accompanying ST4.8×50 wood screws. At 65mm above the four holes, drill a hole of 10mm-diameter and 40-45mm depth (overlarge holes are prohibited). Insert the M6 metal expansion pipe into the hole. (As shown in Figure 10-1)

**3. Adjust the drawing panel:** pull the brackets of the panel up to an appropriate height and then pull the panel sides to find the drawing panel. Remove the protective film, and insert it along the gap between the decorative panel and the housing. Then adjust it to the proper height.

**4. Install the hood body:** fix the check valve as shown in Figure 11. Then direct the hanging holes in the back of hood at the hooks of hitching feet according to Figure 10-1, and press them together. Shake the body to check if it's hung securely. After the body is mounted, install the hitching foot stopper and gaskets to the M6 metal expansion pipe, and then tighten the nuts (to prevent accidental decoupling of the body under external force).

**5. Install the drawing panel:** as shown in Figure 9-1, there are some gap between the drawing panel and the top plate. Push the panel against the top plate and then fix it to the top plate with ST4×18 screws. (if installation method in Figure 9-2 is adopted, there's no need to adjust and install the drawing panel)

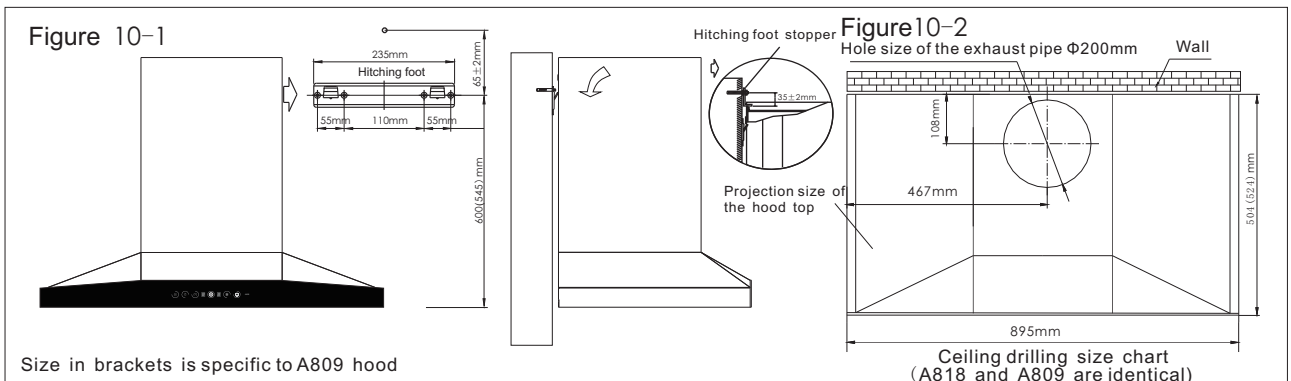

**6. Install the aluminum exhaust pipe:** insert one of the ends in the outer ring of the check valve connection and seal with exhaust pipe tapes. Then, put four snaps of the check valve connection in corresponding slots, and rotate them clockwise to fix the exhaust pipe to the check valve.

Insert the other pipe end to the pipe connection and stick with tapes. Straighten the aluminum exhaust pipe to the outdoors. This can be done directly when the wall hole is larger than the pipe. Otherwise, there are four pipe ends (OD: 140, 150, 160, and 170 respectively) to be chosen from according to the hole size. Then cut the excess part with scissors. (Specific steps are shown in the figure below) In case of connection with the public flue, straighten the aluminum exhaust pipe and connect it to the public flue outlet.

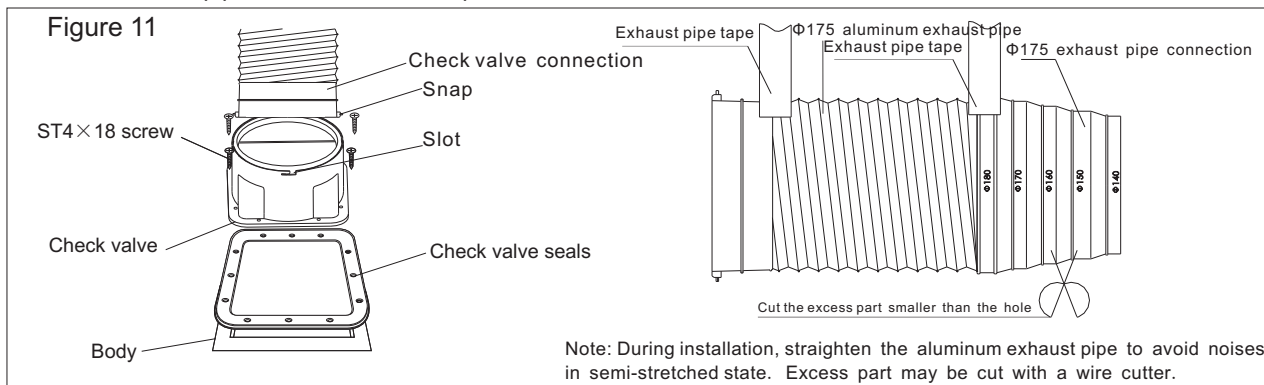

**7. Install the other end of the aluminum exhaust pipe (reference)**

Aluminum exhaust pipe and hob facing the window:

Remove one of the glasses and install a plywood with ventilation holes or punch directly on the glass.

●**Hob away from the window:**

Install the aluminum exhaust pipe through the window that is close to the hob and connected outside, or install it by punching on the wall that is close to the hob and connected outside.

●**Drill hole through the wall:**

Determine the location of the aluminum exhaust pipe against the wall and draw the drilling range (i.e. a circle slightly larger than the pipe OD). Use a long drill bit to drill through the wall. Pay attention to the wall structure and material, so as not to destroy other parts of the wall.

**The hole diameter shall be close to that of the exhaust pipe. Undersized hole will cause poor exhaust efficiency, more noises and lower airflow. The connection between the pipe and the hole or the public flue must be sealed tightly to ensure that, the pipe and the check valve or public flue is connected securely. The blades at the check valve connection or public flue connection must be flexible.**

## Use

**Switch Control Panel**

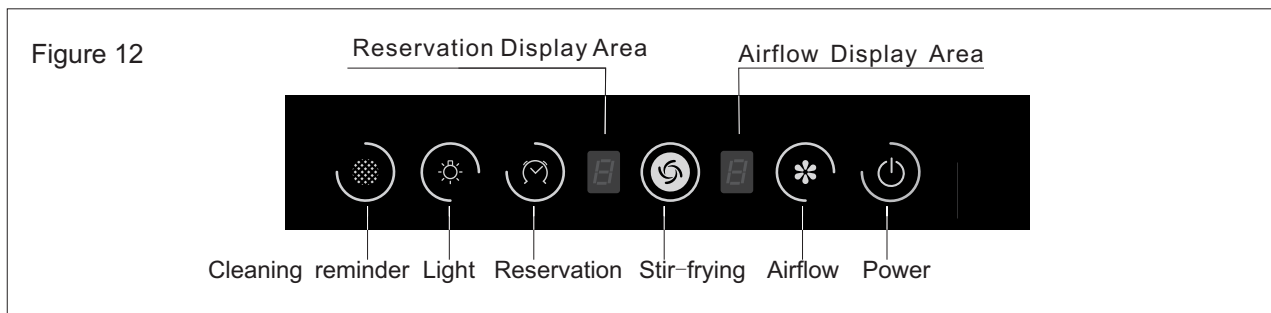
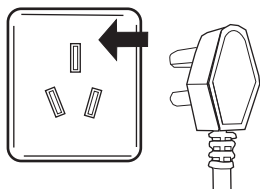

Figure 13



● Plug in and a tick from the buzzer will indicate qualified installation. The hood is in standby. (The picture for reference only, please subject to actual plug)

Figure 14



Light

● Press the light button to turn on the light and repress to turn it off. Each press will trigger a tick from the buzzer. The Lighting Button only controls the spotlight.

Figure 15



Power

● When the power icon is lit up and only the spotlight is “ON”, press the power button gently and the spotlight will be turned off directly; if the fan is working, press the power button, the power icon will flash and the fan will be shut down after 1min. Press the button again, all functions will be disabled.

Figure 16



Stir-frying      Airflow

● Press the stir-frying button, the airflow display area will show “6” for “3” minutes and then automatically switch to “Level-3” airflow. At this time, you may adjust the airflow via the airflow button. Each press will trigger a tick from the buzzer and decrease the airflow by a level.

Figure 17



Reservation

● Press the reservation button when the fan is working, the reservation display area will show “1”, meaning the reservation lasts 10 min. 10 min later, the hood will beep to remind the end of reservation. Press the button twice, the timer display area will show “2”, meaning the reservation lasts 20 min... by this analogy, the maximum reservation is 60 min. Upon end of reservation, press any button to cancel the beep.

Figure 18



Cleaning reminder

● The appliance has a “cleaning reminder” function. After the hood runs for 60h, the “cleaning reminder” icon will keep “ON” while the buzzer beeps to remind the user to clean the oil filter. At this time, the user can keep pressing the button to cancel reminder. Otherwise, the icon will go “OFF” automatically after 1 h.

Figure 19

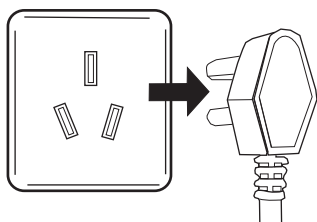

● Please unplug it during long-term shutdown. (The picture for reference only, please subject to actual plug)

Figure 20

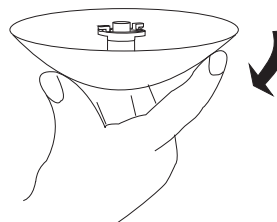

● When the oil reaches above 2/3 of the oil cup, rotate the cup right to toss away the oil.



## Maintenance

**⚠** There is a fire risk if cleaning is not carried out in accordance with the instructions.

The hood shall be cleaned and maintained regularly depending on the surroundings, so as to keep its cleanness & efficiency and extend its service life.

We recommend to:

- Clean the exhaust fume collecting hood and range hood body after each cooking.
- To ensure smooth discharge of fumes, the filter shall be cleaned regularly with warm water and detergent according to actual situations. Be careful to avoid damage.

Note: Cleaning and maintenance must be done when the power is disconnected. Keep the electrical components (e.g. motors, switches and connectors) away from water to avoid accidents.

Figure 21

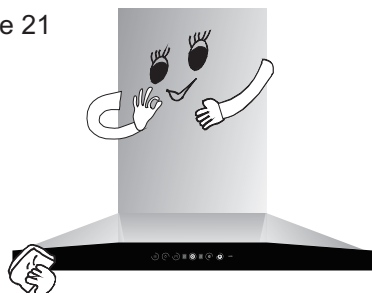

- Suitably wipe it with a wet cloth soaked in mild

Figure 22

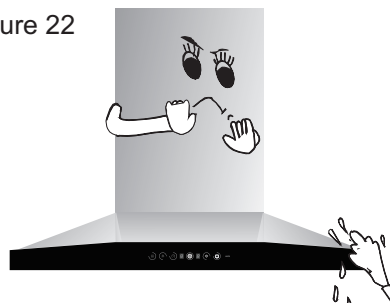

- Don't rinse with water to avoid accidents.

### Light Removal

Figure 23

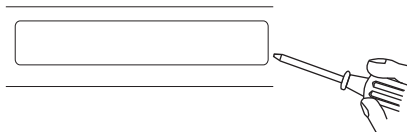

- Insert a small flathead screwdriver or something sharp in the gap between the light cover and hood.

Figure 24

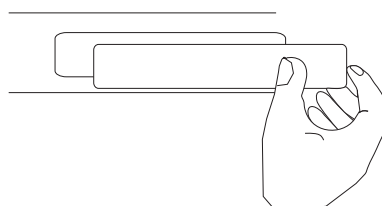

- Raise it outward forcibly to remove the spotlight from the hood. Pull out the connector to replace the spotlight.

### Filter Mesh Removal

Figure 25



- Align the Phillips screwdriver with the screw hole and raise it upward forcibly meanwhile rotating it counter-clockwise about 120°, so as to remove the screw out of the cross slot of the exhaust fume collecting hood.

Figure 26

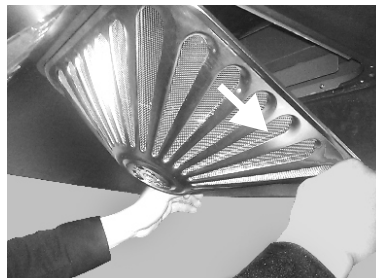

- Hold the two screws on the filter mesh and pull it down to detach the two prongs inside from the exhaust fume collecting hood. Then pull the filter out in the arrow direction to remove it.

Note: When installing the filter mesh, put the side with screw holes inward.

## Switch Removal

Figure 27

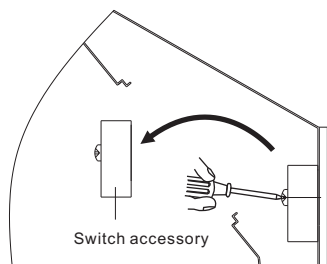

- After removing the light, use a Phillips screwdriver to remove the two screws on the switch. Push the switch assembly diagonally upward to take it out from the lamp hole for repair and replacement.

Note: The light, filter mesh and switch shall be installed in a reverse order.

## General Plan of Body Installation and Removal

Figure 28

Removal steps:

1. Pull out the plug;
2. Unscrew the four screws from the back of the decorative panel. Tilt the panel forward to a certain angle, and then pull it up forcibly;
3. Remove the drawing panel from the decorative panel;
4. Use a Phillips screwdriver to unscrew the fastening screws on the cover to remove the cover;
5. Unscrew the fastening screws on the retaining ring to remove the retaining ring;
6. Unscrew the cap clockwise and take out the impeller vertically;
7. Remove the oil cup as shown in Figure 20 and then remove the filter mesh according to Figure 25-26. The installation and removal procedure in reverse. (When mounting the impeller, apply some lubricant to the shaft hole.)

Note: Step 3 is unnecessary if no drawing panel is installed.

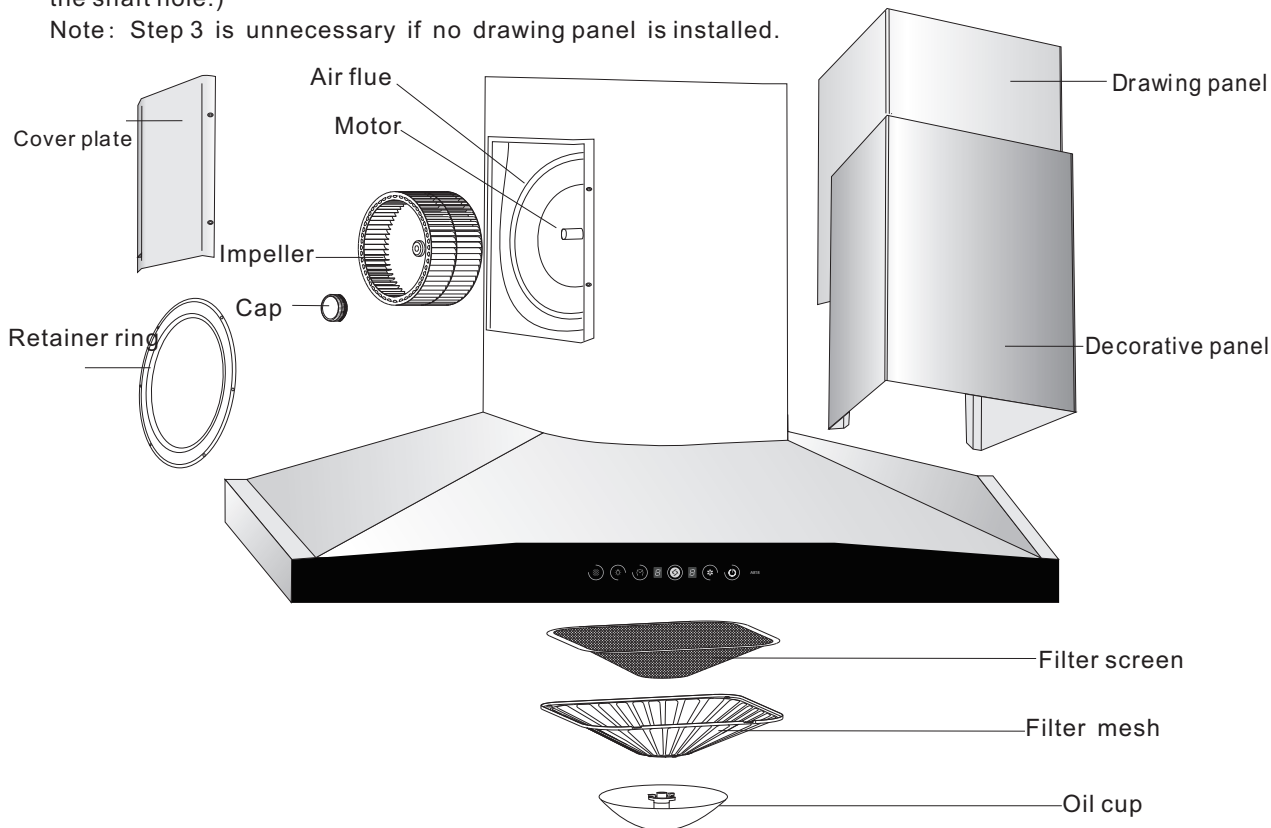

## Electrical Diagram

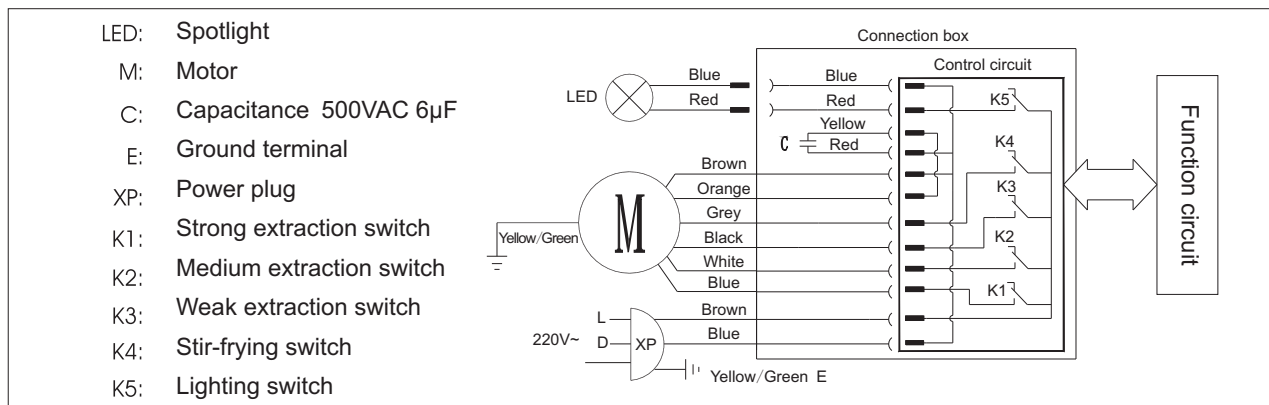

### Warning

There shall be adequate ventilation of the room when the range hood is used at the same time as appliances burning gas or other fuels.

- Do not flambé under the range hood.
- This appliance is not intended for use by persons (including children) with reduced physical, sensory, or mental capacities, or lack of experience and knowledge, unless they have been given supervision or instruction concerning use of the appliance by a person responsible for their safety.
- Children should be supervised to ensure that they do not play with the appliance.
- If the supply cord is damaged, it must be replaced by the manufacturer, its service agent or similarly qualified persons in order to avoid a hazard.
- Accessible parts may become hot when used with cooking appliances.
- The minimum distance between the supporting surface for the cooking vessels on the hob and the lowest part of the range hood. When the range hood is located above a gas appliance, this distance shall be at least 65 cm. If the instructions for installation for the gas hob specify a greater distance, this has to be taken into account.

## General Troubleshooting

No	Failure	Cause	
1	No response after pressing any button (e.g. the impeller does not rotate, light is "OFF")	The power is not connected properly or there is power failure	<p> <b>Warning</b></p> <ol style="list-style-type: none"> <li>1. Please unplug the power cord when connecting the plug-ins or replacing any part.</li> <li>2. If the hood's power cord is damaged, it must be replaced by our maintenance staff.</li> <li>3. Keep the hood away from fire to avoid accidents.</li> </ol>
2	Light "OFF" after pressing the light button	The light is damaged or poorly connected	
3	Induced current on the hood body that paralyzes hands	The power outlet is not well	
4	Abnormal sound during impeller running	The impeller is loose and the cap is not tightened	
5	No oil in the oil cup after a period of time	The body is tilt	

For other failures, please contact the vendor, special service center or our service center directly.

Edition: A/1

**ROBAM**